



Model Number:
WGB-XX-197028

RF Components

C-Band Broadwall Coupler

5.85 - 8.2GHz

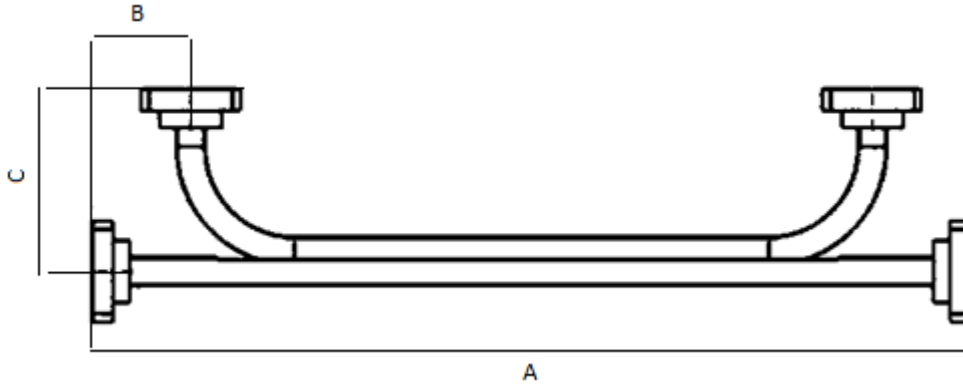

Specification				
WG Size	WG14 / WR137/ R70			
Coupling	20±2.0 dB	30±2.0 dB	35±2.0 dB	40±2.0 dB
Frequency Range	5.85-8.20 GHz			
Finish	Brass Flanges Copper WG Black Paint			
Flange Options	CPR 137G (CG) / CPR 137F (CF) PDR 70 (PD) / UDR 70 (UD) UG344/U (US) / UAR 70 (UA) / PAR 70 (PA) UG343B/U (UG) / UG344/U (UF)			
Main Line VSWR / Return Loss (max)	1.05:1 / 32.3	1.05:1 / 32.3	1.05:1 / 32.3	1.05:1 / 32.3
Secondary Arm VSWR/ Return Loss (max)	1.1:1	1.1:1	1.1:1	1.1:1
Directivity (min over 75% Bandwidth)	>= 25 dB	>= 25 dB	>= 25 dB	>= 25 dB
Dimensions	A-475mm B-40mm C-125mm			

Model Numbers Example: WGB-20-197028-UBPB					
WG	B	20	197056	UB	PB
Waveguide	C-Cross Guide D-Dual Arm B-Broad wall	Coupling Factor	Model Number	Left Hand Flanges	Right Hand Flanges

Broadcast



Marine Oil & Gas



SNG & VSAT



Satellite Teleport

